

PLC SERIES CONNECTOR



The **1/4" flow PLC Series** is proven worldwide in thousands of applications and offers the widest selection of sizes and configurations. PLC couplings are injection molded from acetal thermoplastic and are resistant to most mild chemical solutions. One-hand connection/disconnection, plus integral terminations make the PLC Series the choice for ease of use and manufacture.

FEATURES

CPC thumb latch

Integral terminations

Clicks when connected

Compatible

BENEFITS

One-hand connection and disconnection

Fewer leak points, shorter assemblies, faster installations

Assurance of a reliable connection

Mates with LC and PLC12 Series couplings

PLC Air Flow, 100 psig Inlet Pressure

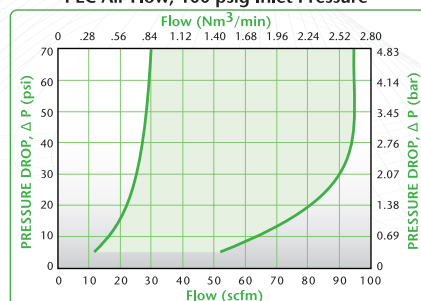

PLC Water Flow

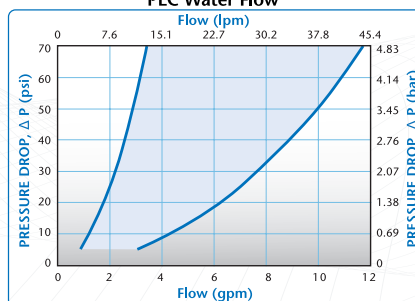

PLC Pressure Range

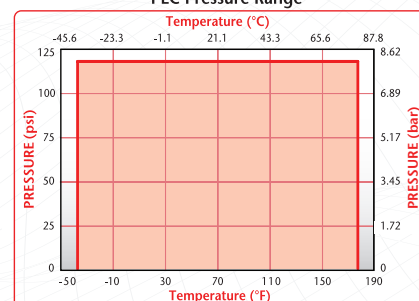

These graphs are intended to give you a general idea of the performance capabilities of each product line. The shaded area of each graph represents the operating range of the product family, i.e., upper and lower values are shown. Therefore, depending on the exact coupling configurations selected, you can reasonably expect values to fall within the shaded area.

Specifications

PRESSURE:

Vacuum to 120 psi, 8.3 bar

TEMPERATURE:

-40°F to 180°F (-40°C to 82°C)

MATERIALS:

Main components and valves: Acetal

Thumb latch: Stainless steel

Valve spring: 316 stainless steel

External springs and pin: Stainless steel

O-rings: Buna-N

COLOR: Natural white, others available

TUBING SIZES:

1/4" to 3/8" ID, 6.4mm to 9.5mm ID

JG® TUBING SPECIFICATIONS:

Tube tolerances: 1/4" OD, +0.001/-0.004 | 3/8" OD, +0.001/-0.004

Tube Types: Plastic tube: Polyethylene, nylon, polyurethane. For soft or thin wall tubing with JG® terminations, tube supports are recommended.

Metal tube: Brass, copper and mild steel

Also available in NSF listed versions, please visit our website for part number information.



Decoding Coupling Options

Often times, it can be an overwhelming task to decipher which coupling best fits your application needs. The chart below helps to decode popular CPC couplings.

1/4" FLOW OPTIONS	PRIMARY MATERIAL	O-RING	APPLICATION BENEFITS
PLC	Acetal	Buna-N	General purpose plastic connector with metal latch
PLC12	Polypropylene	EPDM	Expanded chemical compatibility
LC	Chrome-Plated Brass	Buna-N	Higher operating temperature and pressure
APC	Acetal	Buna-N	Plastic thumb latch
BREAKAWAY®	Acetal	Buna-N	Breakaway latch
NS4	Glass-filled polypropylene	EPDM	Drybreak, non-spill connect and disconnect, even under pressure

For further information please contact CPC Customer Service at 1-800-444-2474 or 651-645-0091.

Liquid Flow Rate Information for Couplings

The chart below shows the flow rate for CPC couplings. Each coupling was tested with water at 70°F (21°C). To determine flow rates for specific coupling configurations use the formula at the right.

$$Q = C_v \sqrt{\frac{\Delta P}{S}}$$

Q = Flow rate in gallons per minute
 C_v = Average coefficient across various flow rates (see chart)
 ΔP = Pressure drop across coupling (psi)
 S = Specific gravity of liquid

C_v VALUES FOR 1/4" FLOW PLC COUPLINGS

	PLC 20004	PLCD 20004	PLC 20006	PLCD 20006	PLC 22004	PLCD 22004	PLC 22006	PLCD 22006	PLC 24004	PLCD 24004	PLC 24006	PLCD 24006	PLC 26004
BODIES INSERTS													
PLC10004	.40	.36	1.05	.58	.83	.56	1.40	.82	1.40	.75	1.40	.77	.83
PLCD10004	.36	.31	.73	.48	.66	.41	.82	.50	.80	.45	.77	.45	.81
PLC10006	.40	.36	1.05	.60	.83	.56	1.40	.81	1.40	.76	1.40	.76	.83
PLCD10006	.37	.31	.81	.47	.70	.43	1.02	.51	.98	.46	.99	.48	.98
PLC12006	.38	.36	.84	.63	.74	.56	1.14	.75	1.14	.70	1.14	.72	.74
PLCD12006	.38	.33	.78	.49	.68	.44	.84	.49	.81	.43	.82	.44	.81
PLC16004	.38	.37	.87	.54	.95	.51	1.00	.70	.95	.64	1.00	.66	.95
PLCD16004	.37	.31	.61	.44	.57	.41	.78	.44	.78	.43	.75	.46	.78
PLC16006	.38	.37	1.00	.57	.95	.53	1.40	.80	1.40	.71	1.40	.73	1.40
PLCD16006	.38	.32	.71	.49	.63	.42	.89	.51	.96	.45	.92	.49	.97

Smart fluid handling to take you forward, faster.

COPYRIGHT © 2020 COLDER PRODUCTS COMPANY. All rights reserved. Colder Products Company, Colder Products and CPC are all registered trademarks with the US Patent & Trademark Office.

PLC DIMENSIONS

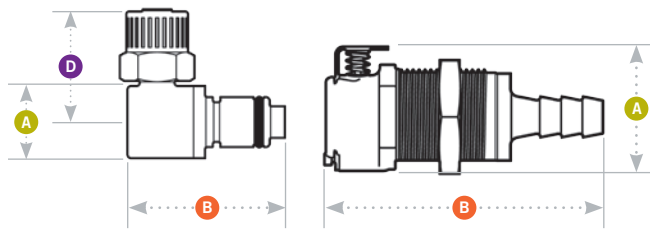

- A = Height/Diameter
- B = Total Length
- D = Elbow Radial Length

Panel Dimensions

	PANEL OPENING	PANEL THICKNESS MAX.-MIN.	PANEL NUT HEX	PANEL NUT THREAD
COUPLING BODIES	see drawing	.50 - .05	13/16	11/16-24UNEF
COUPLING INSERTS	see drawing	.30 - .05	13/16	11/16-24UNEF

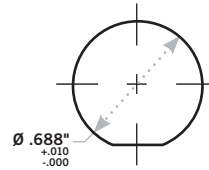

Coupling Bodies • ACETAL

	TERMINATION IN-LINE PIPE THREAD	TUBING/THREAD SIZE	METRIC EQ.	STRAIGHT THRU	SHUTOFF	A	B
	1/4" NPT	1/4" OD, .17" ID	6.4mm OD, 4.3mm ID	PLC10004	PLCD10004	.90	1.17
	1/4" BSPT		8.0mm OD, 6.0mm ID	PLC10004BSPT	PLCD10004BSPT	.90	1.15
	3/8" NPT	3/8" OD, .25" ID	9.5mm OD, 6.4mm ID	PLC10006	PLCD10006	.90	1.15
	3/8" BSPT		10.0mm OD, 8.0mm ID	PLC10006BSPT	PLCD10006BSPT	.90	1.15
		1/4" ID	6.4mm ID	PLC12004	PLCD12004	.88	1.87
		5/16" ID	7.9mm ID	PLC120M8	PLCD120M8	.88	1.95
		3/8" ID	9.5mm ID	PLC12006	PLCD12006	.88	1.95
				PLC120M10	PLCD120M10	.88	1.95
		1/4" ID	6.4mm ID	PLC16004	PLCD16004	.88	1.95
		5/16" ID	7.9mm ID	PLC16005	PLCD16005	.88	1.95
		3/8" ID	9.5mm ID	PLC16006	PLCD16006	.88	1.95
		1/4" OD	6.4mm OD	PLC11004	PLCD11004	.88	1.95
		1/4" OD, .17" ID	6.4mm OD, 4.3mm ID	PLC13004	PLCD13004	.94	1.82
			8.0mm OD, 6.0mm ID	PLC130M8	PLCD130M8	.94	1.95
		3/8" OD, .25" ID	9.5mm OD, 6.4mm ID	PLC13006	PLCD13006	.94	1.95
			10.0mm OD, 8.0mm ID	PLC130M10	PLCD130M10	.94	1.95
		1/4" ID	6.4mm ID	PLC17004	PLCD17004	.94	1.80 / 1.95
		5/16" ID	7.9mm ID	PLC17005	PLCD17005	.94	1.95
		3/8" ID	9.5mm ID	PLC17006	PLCD17006	.94	1.80 / 1.95
		1/4" OD	6.4mm OD	PLC14004	PLCD14004	.94	1.95
		3/8" OD	9.5mm OD	PLC14006	PLCD14006	.94	2.09
		(See page 162 for JG accessories)					

All measurements are in inches (millimeters) unless otherwise noted. Tubing must meet stated inside and outside diameters.
 †NOTE: CPC's Ferruleless Polytube Fitting terminations do not require ferrules to achieve a secure connection, which makes them easier to use and reuse. PTF fittings are designed for semi-rigid tubing, i.e., polyethylene, nylon, polyurethane, etc. NOTE: JG is a registered trademark of John Guest USA, Inc.

Coupling Inserts • ACETAL



TERMINATION IN-LINE PIPE THREAD

PANEL MOUNT FERRULELESS POLYTUBE FITTING, PTF†

PANEL MOUNT HOSE BARB

PANEL MOUNT JG® PUSH-TO- CONNECT

IN-LINE FERRULELESS POLYTUBE FITTING, PTF†

IN-LINE HOSE BARB

IN-LINE JG® PUSH-TO- CONNECT

ELBOW FERRULELESS POLYTUBE FITTING, PTF†

ELBOW HOSE BARB

TUBING/THREAD SIZE METRIC EQ.

STRAIGHT THRU

SHUTOFF

A

B

D

1/4" NPT			PLC24004	PLCD24004	.72	1.25/1.66	
1/4" BSPT			PLC24004BSPT	PLCD24004BSPT	.72	1.53/1.66	
3/8" NPT			PLC24006	PLCD24006	.87	1.25/1.63	
3/8" BSPT			PLC24006BSPT	PLCD24006BSPT	.87	1.51/1.63	
1/4" OD, .17" ID	6.4mm OD, 4.3mm ID		PLC40004	PLCD40004	.94	1.78/1.91	
	8.0mm OD, 6.0mm ID		PLC400M8	PLCD400M8	.94	1.91/2.03	
3/8" OD, .25" ID	9.5mm OD, 6.4mm ID		PLC40006	PLCD40006	.94	1.91/2.05	
	10.0mm OD, 8.0mm ID		PLC400M10	PLCD400M10	.94	1.91/2.05	
1/4" ID	6.4mm ID		PLC42004	PLCD42004	.94	1.91/2.05	
5/16" ID	7.9mm ID		PLC42005	PLCD42005	.94	1.91/2.05	
3/8" ID	9.5mm ID		PLC42006	PLCD42006	.94	1.91/2.05	
1/4" OD	6.4mm OD		PLC41004	PLCD41004	.94	1.91/2.05	
1/4" OD, .17" ID	6.4mm OD, 4.3mm ID		PLC20004	PLCD20004	.72	1.25/1.88	
	8.0mm OD, 6.0mm ID		PLC200M8	PLCD200M8	.72	1.38/1.82	
3/8" OD, .25" ID	9.5mm OD, 6.4mm ID		PLC20006	PLCD20006	.72	1.38/1.82	
	10.0mm OD, 8.0mm ID		PLC200M10	PLCD200M10	.72	1.38/1.82	
1/4" ID	6.4mm ID		PLC22004	PLCD22004	.62	1.35/1.99	
5/16" ID	7.9mm ID		PLC22005	PLCD22005	.62	1.35/1.99	
3/8" ID	9.5mm ID		PLC22006	PLCD22006	.62	1.36/1.81	
1/4" OD	6.4mm OD		PLC29004	PLCD29004	.63	1.35/1.95	
3/8" OD	9.5mm OD		PLC29006	PLCD29006	.78	1.51/2.11	
3/8" OD, .25" ID	9.5mm OD, 6.4mm ID		PLC21006	PLCD21006	.61/.62	1.22/1.35	.85/.96
1/4" ID	6.4mm ID		PLC23004	PLCD23004	.67/.63	1.10/1.28	.85/.96
3/8" ID	9.5mm ID		PLC23006	PLCD23006	.67/.63	1.25/1.28	.90/.96

All measurements are in inches (millimeters) unless otherwise noted. Tubing must meet stated inside and outside diameters. Couplings are pictured with valves unless otherwise noted.

†NOTE: CPC's Ferruleless Polytube Fitting terminations do not require ferrules to achieve a secure connection, which makes them easier to use and reuse. PTF fittings are designed for semi-rigid tubing, i.e., polyethylene, nylon, polyurethane, etc. NOTE: JG is a registered trademark of John Guest USA, Inc.

Smart fluid handling to take you forward, faster.

COPYRIGHT © 2020 COLDER PRODUCTS COMPANY. All rights reserved. Colder Products Company, Colder Products and CPC are all registered trademarks with the US Patent & Trademark Office.



Distributed by:



Infiltec GmbH
Alte Rheinhäuser Str. 6-8
67346 Speyer am Rhein

Tel: +49 6232 100332 0
Fax: +49 6232 100332 42
info@infiltec.de
infiltec.de

COLDER PRODUCTS COMPANY
2820 CLEVELAND AVE. N.
ROSEVILLE, MN 55113
U.S.A.

PHONE: +1 651-645-0091
FAX: +1 651-645-5404

info@cpeworldwide.com
cpeworldwide.com

COLDER PRODUCTS COMPANY GMBH
KURHESSENSTR. 15
64546 MÖRFELDEN-WALLDORF
GERMANY

PHONE: +49-6026-9973-0

cpcgmbh@cpeworldwide.com
cpcpworldwide.com

COLDER PRODUCTS COMPANY LIMITED
LEVEL 19,
TWO INTERNATIONAL FINANCE CENTRE
8 FINANCE STREET, CENTRAL, HONG KONG

PHONE: +852 2987-5272
FAX: +852-2987-2509

asiapacific@cpeworldwide.com
cpcpworldwide.com



CPC WARRANTY STATEMENT: CPC (Colder Products Company) warrants its products against defects in workmanship and materials for a period of 12 months from the date of sale by CPC to its initial customer (regardless of any subsequent sale of the products). This warranty is void if the product is misused, altered, tampered with or is installed or used in a manner that is inconsistent with CPC's written recommendations, specifications and/or instructions, or fails to perform due to normal wear and tear. CPC does not warrant the suitability of the product for any particular application. Determining product application suitability is solely the customer's responsibility. CPC is not liable for special, indirect, incidental, consequential or other damages including, but not limited to, loss, damage, personal injury, or any other expense directly or indirectly arising from the use of or inability to use its products either separately or in combination with other products. ALL OTHER WARRANTIES EXPRESS OR IMPLIED, WHETHER ORAL, WRITTEN OR IN ANY OTHER FORM, INCLUDING BUT NOT LIMITED TO WARRANTIES OF MERCHANTABILITY OR FITNESS FOR A PARTICULAR PURPOSE, ARE EXPRESSLY EXCLUDED. The sole and exclusive remedy under this warranty is limited, at the option of CPC, to replacement of the defective product or an account credit in the amount of the original selling price. All allegedly defective CPC products must be returned prepaid transportation to CPC, together with information describing the product's application and performance, unless otherwise authorized in writing by CPC.

CPC PATENT STATEMENT: CPC takes pride in its innovative quick disconnect coupling and fittings solutions, many of which have been awarded United States and international patents. CPC has a strong tradition of

leadership in the quick disconnect market, and aggressively pursues and protects its proprietary information and intellectual property. In cases where it is practical and has a benefit to its customers, CPC has licensed its proprietary technology. Please contact CPC to discuss your unique needs.

CPC TRADEMARK STATEMENT: AseptiQuik®, BottleQuik®, BreakAway®, ChemQuik®, DrumQuik®, FitQuik®, IdentiQuik®, Nu-Seal®, SnapQuik®, Steam-Thru®, Softube® are registered trademarks with the U.S. Patent & Trademark Office. All other trademarks or service marks are property of their respective owners. **WARNING:** Due to the wide variety of possible fluid media and operating conditions, unintended consequences may result from the use of this product, all of which are beyond the control of CPC. It is the user's responsibility to carefully determine and test for compatibility for use with their application. All such risks shall be assumed by the buyer.

COPYRIGHT © 2020 COLDER PRODUCTS COMPANY. All rights reserved. Colder Products Company, Colder Products and CPC are all registered trademarks with the US Patent & Trademark Office.

WARNING: Due to the wide variety of possible fluid media and operating conditions, unintended consequences may result from the use of this product, all of which are beyond the control of CPC. It is the user's responsibility to carefully determine and test for compatibility for use with their application. All such risks shall be assumed by the buyer.

CAT2020 4/17